

### SHPF Series

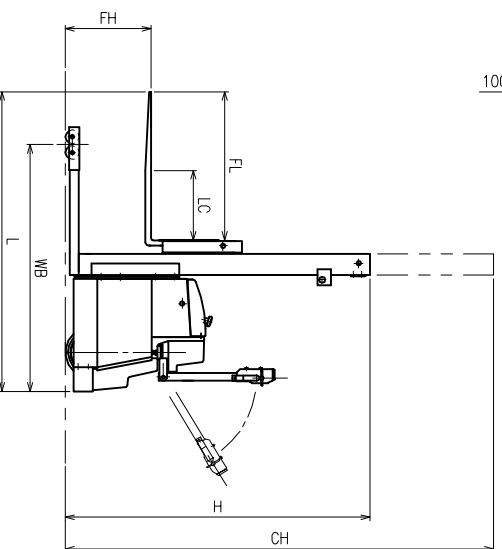
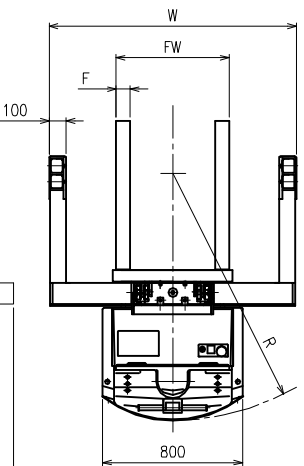

Model Type	SHPF6S		SHPF6W		SHPF8S		SHPF8W		SHPF1S		SHPF1W	
	Unit	kg	600	600	800	800	600	600	950	950	630	630
Maximum Load	LC	mm										
Load Center	FH	mm	60~1500	60~2480	60~1500	60~2480	60~1500	60~2480	60~1500	60~2480		
Lifting Height	With	mm/sec	85	85	80	80	120	120	120	120		
Lifting Speed	Without	mm/sec	120	120	120	120	120	120	120	120		
Driving Speed	With	km/h	3.7	3.7	3.5	3.5	4.2	4.2	4.2	4.2		
	Without	km/h	4.2	4.2	4.2	4.2	4.2	4.2	4.2	4.2		
Minimum Turning Radius	R	mm			R1420	R1420			R1420	R1420		
	L	mm			1730	1730						
Length	L	mm			1415	1415						
	W	mm			1975	1740	1990	1740	1990	1740		
Height (Fork in Lowest Position)	H	mm	1975	1740	1990	1740	1990	1740	1990	1740		
	CH	mm	2040	3020	2040	3020	2040	3020	2040	3020		
Height (Fork in Highest Position)	WB	mm			1200	1200						
	FL	mm			850	850						
Fork Overall Width	FW	mm			645~200	645~200						
	F	mm			80	80						
Service Weight		kg	550	620	560	620	570	630				
Drive Wheel		mm			φ 280x80 (Urethane) 1piece							
Load Wheel		mm			φ 78X70 (Urethane) 2pieces	φ 78X70 (Urethane) 4pieces	φ 78X70 (Urethane) 4pieces	φ 78X70 (Urethane) 4pieces				
Caster Wheel		mm			-							
Battery Voltage		V			24							
Battery Capacity		Ah/5HR			65	100	100	100				
Battery Charger					Stationary Type Automatic Battery Charger (Single Phase 100V)							
Drive Motor		kw			0.8							
Running Control					Rheostatic Control							
Hydraulic Motor		kw			1.5							